



### ADVANTAGES

- Easy Maintenance Operations
- Energy saving
- Excellent Chemical Resistance
- Robust Construction

### FEATURES

- External Mechanical Seal available with different material combinations
- Tmax exercise: PP75°C - PVDF 95°C - PVC 50°C
- Connections:
  - Threaded
  - Flanged

### APPLICATIONS FIELDS

- Acid and alkaline solutions with minimal suspended particles
- Electroplating, Chemical, PCB Industry

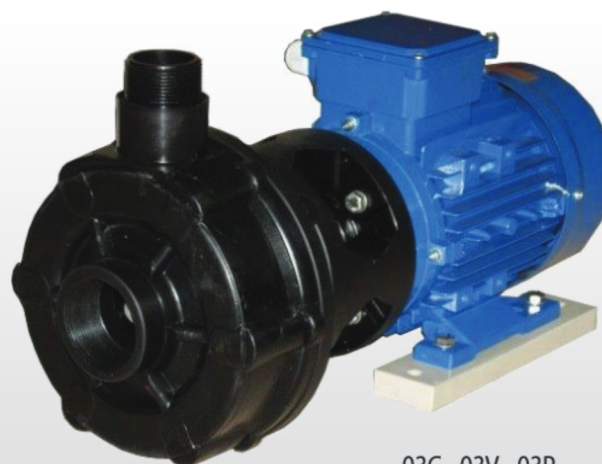

03C - 03V - 03P

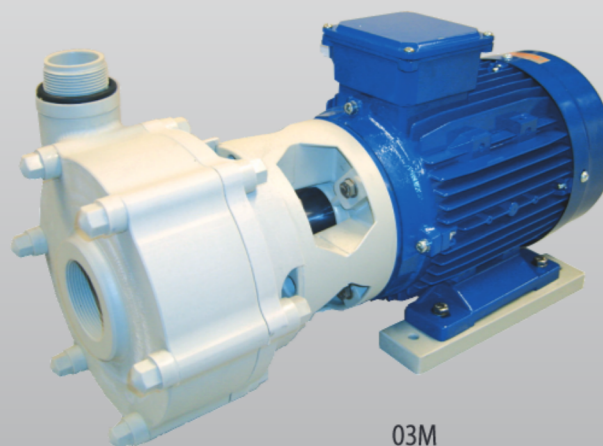

03M

	Flow Rate max (l/min.)	Head max (m)	Motor	
			(kw)	(HZ)
03A1	380	20	1,5	50/60
03A2	470	20	2,2	50/60
03A3	600	20	4,0	50/60
03B1	550	24	3,0	50/60
03B2	650	24	4,0	50/60
03B3	700	28	5,5	50/60

### PUMP IDENTIFICATION

Model	Pump body	Shaft	Mechanical Seal / Rotating-Static	Oring	Motor/Rpm	Optional
03A1 03A2 03A3 03B1 03B2 03B3	P = PP molded M = PP solid C = PVC V = PVDF	X = SS 316 T = Titanium H = Hastelloy	1 = PTFE/Ceramic 4 = Sic/Carbon 5 = Sic/Sic 6 = Carbon/Ceramic 7 = Sic/Sic with anti-rotation pin	E = EPDM V = Viton	A = 50Hz/2800 B = 60Hz/3400	F = Flange
03B2	P	H	6	E	A	F

## Performance Curve 50 Hz - Rpm 2800

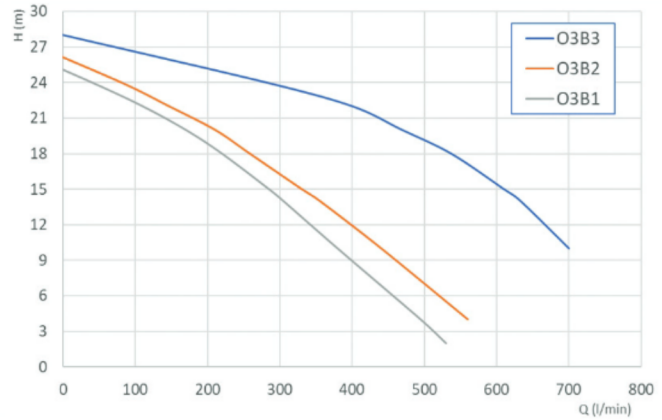
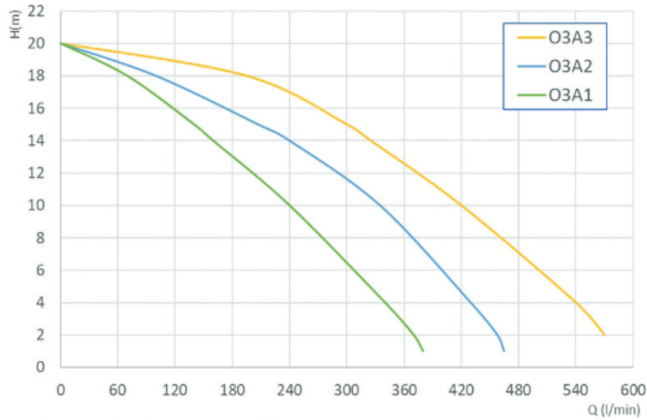

Curves referred to water = 20°C

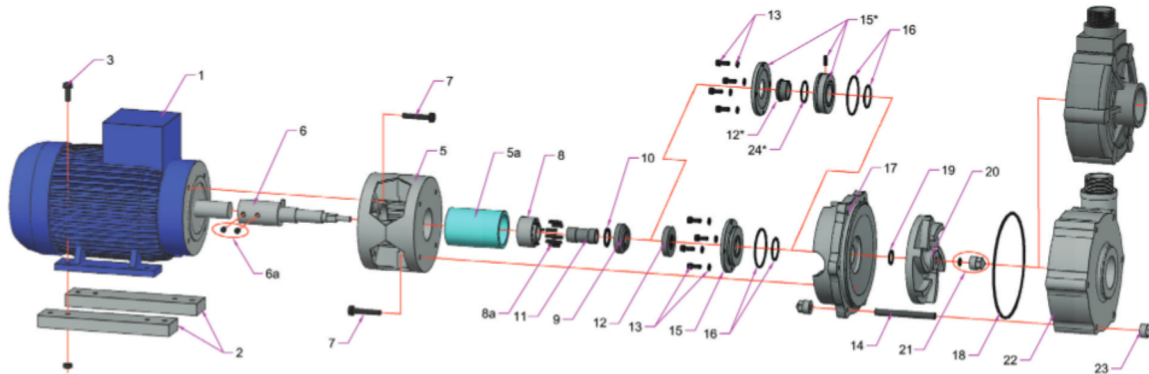

- |                      |  |  |   |
|----------------------|--|--|---|
| 1 Motor              | 8 Mechanical seal body                 | 14 Pump housing tie rod                        | 20 Impeller                                   |
| 2 PP motor support   | 8a Spring mechanical seal body         | 15 Static ring housing                         | 21 Ogive kit                                  |
| 3 Motor fixing screw | 9 Rotating ring                        | 15* Static ring with anti rotation pin housing | 22 Pump housing                               |
| 5 Bracket            | 10 O-Ring                              | 16 Static ring housing O-Ring                  | 23 Pump housing nut                           |
| 5a Bracket           | 11 Shaft cover                         | 17 Pump housing flange                         | 24* Static ring with anti rotation pin O-Ring |
| 6 Shaft              | 12 Stating ring with anti rotation pin | 18 Pump housing O-Ring                         |   |
| 6a Grub screw        | 12* Stating ring Long Tail             | 19 Impeller O-Ring                             |   |
| 7 Bracket screws     | 13 Mechanical seal flange screw        |  |   |

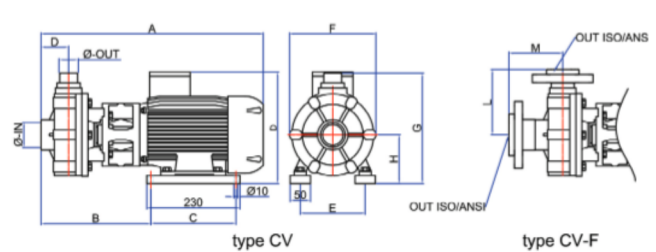
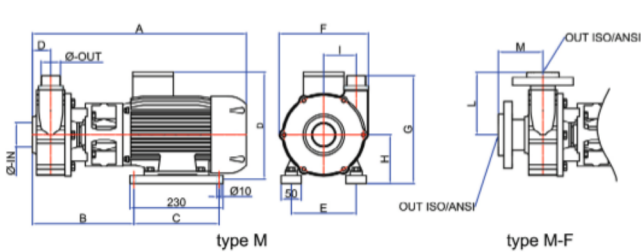

Pump Dimension serie "O3"														
MOD.		A	B	C	D	E	F	G	H	I	L	M	Ø-IN	Ø-OUT
O3A1	M	482	233	200	45	140	223	233	110	81	154	110	2"	1 1/2"
	CV	502	253		68			253			166	133		
O3A2	M	509	245	200	45	140	223	245	110	81	154	110	2"	1 1/2"
	CV	529	265		68			265			166	133		
O3A3	M	534	260	200	45	160	223	260	120	81	154	110	2"	1 1/2"
	CV	554	280		68			280			166	133		
O3B1	M	534	260	200	45	160	223	260	120	81	154	110	2"	1 1/2"
	CV	554	280		68			280			166	133		
O3B2	M	534	260	200	45	160	223	260	120	81	154	110	2"	1 1/2"
	CV	554	280		68			280			166	133		
O3B3	M	545	260	200	45	190	223	260	132	81	154	110	2 1/2"	1 1/2"
	CV	565	280		68			280			166	133	2"	

LAFONTE.EU may modify data any time, without notice, in order to get product enhancement