

DIMENSIONI  
DIMENSION

- \* A | Attacco Connection
- B | Attacco Connection
- C | Attacco Connection

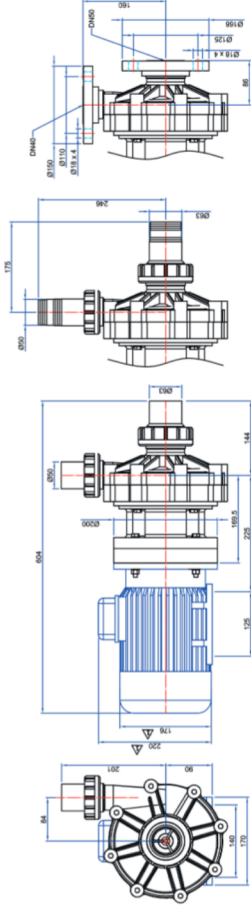

\* A



Manicotto  
Coupling

- A Attacco per tubazione rigida
- B Attacco per tubazione flessibile con porta gomma
- C Attacco per tubazione rigida con flange

- A Connection for rigid piping
- B Connection for flexibles hoses
- C Flanged connection



Saldatura a testa  
Socket fusion

- Δ Può variare in conformità al motore utilizzato

- Δ It changes according with motor supplier

CURVE  
PERFORMANCE

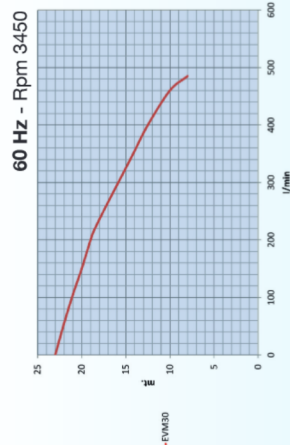
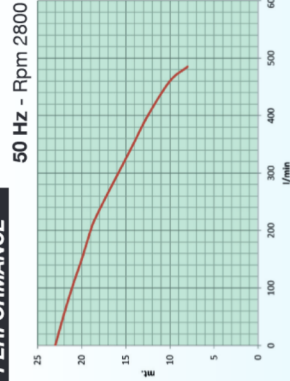

IDENTIFICAZIONE POMPA

Modello Model	Albero Shaft	Tipo tenuta meccanica Rotante - Statica Mechanical seal Rotating - Static	O-Ring O-Ring	Attacchi Connections	Motore Motor
EVM 30	X= AISI 316 T= TITANIO H=HASTELLOY	2 = PTFE - Al <sub>2</sub> O <sub>3</sub> 99,7% PTFE - Al <sub>2</sub> O <sub>3</sub> 99,7% 3= GRAFITE - Al <sub>2</sub> O <sub>3</sub> 99,7% Carbon - Al <sub>2</sub> O <sub>3</sub> 99,7% 4= SIC - SIC	E = EPDM V = VITON	B = Bocchettoni Socket union F = Flangiati Flanged P = Portagonna Hosebarb	A = 50 Hz Rpm 2800 B = 60 Hz Rpm 3450

PUMP IDENTIFICATION

Mat. corpo pompa Pump body	Albero Shaft	Tipo tenuta meccanica Rotante - Statica Mechanical seal Rotating - Static	O-Ring O-Ring	Attacchi Connections	Motore Motor
P = PP F = PVDF	X= AISI 316 T= TITANIO H=HASTELLOY	2 = PTFE - Al <sub>2</sub> O <sub>3</sub> 99,7% PTFE - Al <sub>2</sub> O <sub>3</sub> 99,7% 3= GRAFITE - Al <sub>2</sub> O <sub>3</sub> 99,7% Carbon - Al <sub>2</sub> O <sub>3</sub> 99,7% 4= SIC - SIC	E = EPDM V = VITON	B = Bocchettoni Socket union F = Flangiati Flanged P = Portagonna Hosebarb	A = 50 Hz Rpm 2800 B = 60 Hz Rpm 3450

EVM 30	P	X	3	E	B	A
--------	---	---	---	---	---	---



DATI TECNICI  
SPECIFICATION

Portata max Maximum capacity	Prevalenza max Total head	Motore Motor	IN/OUT D mm	T max esercizio °C T max exercise °C	Peso Kg
485	23	2,2	63 x 50	PP=75°C PVDF=95°C	22
485	23	2,2			25

\* Può variare in conformità al motore utilizzato \* It changes according with motor supplier

ESPLOSO  
EXPLODED VIEW

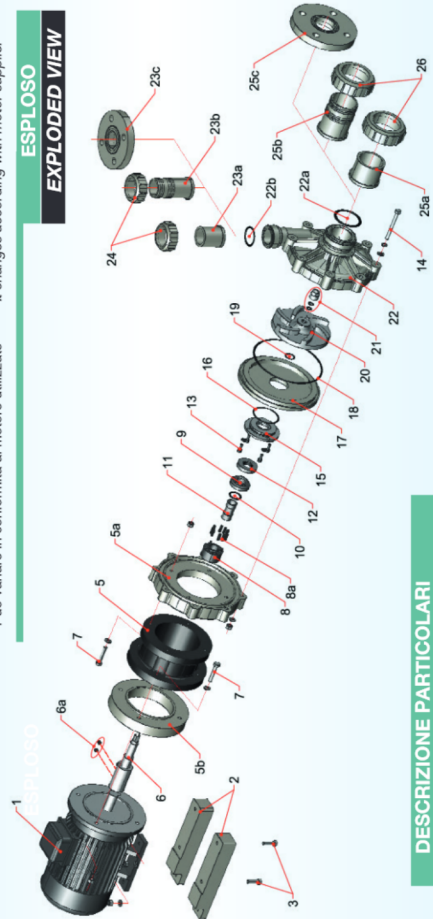

DESCRIZIONE PARTICOLARI  
PART. DESCRIPTION

1 Motore - Motor	14 Vite fiss. corpo pompa - Pump housing screw
2 Base - Motor base	15 Flangia tenuta meccanica - Mechanical seal flange
5.a.b. Lanternotto - Bracket	16 O-RING flangia ten. mecc. - Mechan. seal flange O-RING
6 Albero - Shaft	17 Flangia corpo - Pump housing flange
6a Grani - grub screw	18 O-RING corpo pompa - Pump housing O-RING
7 Viti lanternna - Bracket screw	19 O-RING girante - Impeller O-RING
8 Corpo tenuta meccanica - Mechanical seal body	20 Girante - Impeller
8a Molle tenuta meccanica - Mechanical seal springs	21 Ogiva - Olive nut
9 Anello rotante - Rotating ring	22 Corpo pompa - Pump body
10 O-RING tenuta - O-RING	23 Raccordo mandata - Discharge manifold
11 Rivestimento albero - Shaft sleeve	24 Ghiera mandata - Suction manifold
12 Anello statico - Stating ring	25 Raccordo aspirazione - Suction manifold
13 Bullone flangia ten. mecc. - Mech. seal flange screw	26 Ghiera aspirazione - Suction gear